

Model:YWF(K)6E630-Z-B5A

Fan type:AC Axial fan

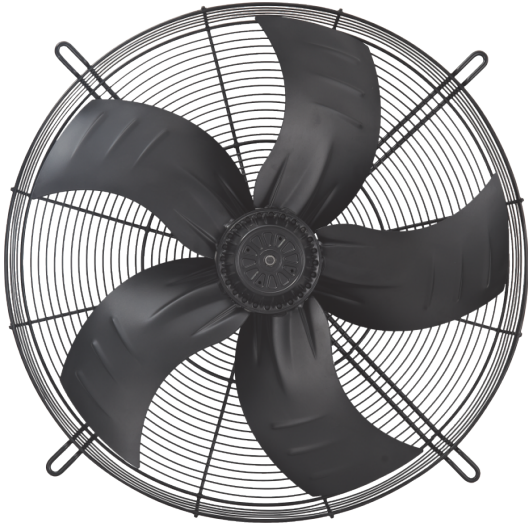

Manufactory:Zhejiang MingZhen Electric & Electronic Co., Ltd.

ADD:The Central Industry Zone, Chengnan Town,  
WenLing City, Zhejiang Province, China

TEL:0086-576-86268888

FAX:0086-576-86268020

Mail:info1@cnsanmu.com

WEB:http://www.cnsanmu.com

## Fan Introduction

This product consist of outer rotor(AC)motor, axial impeller, with features of compact structure, convenient installation, reliable operation, low noise, energy saving etc..

## Scope of application

General purpose fan, can be widely used in purification of air conditioning systems, ventilation duct dust, environmental protection, refrigeration equipment and other fields.

## Environmental requirements

- Operating ambient temperature range:-35℃~+60℃
- Working environment humidity range:≤90%
- Transportation and storage temperature range:-40℃~+80℃
- Transportation and storage environment humidity range:≤80%
- The storage place is well ventilated, corrosive gases not contained.

Model:YWF(K)6E630-Z-B5A

Fan type:AC Axial fan

## Design, manufacturing, testing standards and certification

- JB/T 10562 Technical specification for general purposes axial fans
- GB/T 14711 Safety requirements of small and medium size rotating electrical machines
- GB/T 755/IEC60034-1 Rotating electrical machines - Part 1: Rating and performance
- GB 4706.32-2012/IEC 60335-2-40:2005 Household and similar electrical appliances - Safety - Part 2-40: Particular requirements for electrical heat pumps, air-conditioners and dehumidifiers
- Balance quality grade for rotor is G6.3, in accordance with ISO 1940-1,
- Vibration testing and velocity is performed according to JB/T 8689.
- This product is certified by China CCC and EU CE
- ISO 9001 quality system certification

## Technical features

Mass	15 kg
Size	φ630 mm
Impeller material	cold rolled sheet steel
Direction	Blow(Seen from cable exit)
Protection class	IP54
Insulation class	F
Mounting	Shaft horizontal or rotor on bottom; rotor on top on request
Mode of operation	S1(Continuous operation)
Bearings	Maintenance-free ball bearings
Thermal protector	Can be built in or out of line according to requirements

## Structures

Blades count	5
Impeller type	Conventional welding blade
Attachment	Hight Concave Guard Grille

## Technical parameters

Supply	1P,220~240V
Frequency	50 Hz
Motor poles	6

Model:YWF(K)6E630-Z-B5A

Fan type:AC Axial fan

Rated voltage	230 VAC
Power input	500 W
Rated current	2.2 A
Rated speed	930 r/min
Max airflow	9200 m³/h (Static pressure=0Pa)
Acoustic	75 dB(A) measured at 1.0m from inlet side

## Performance curve

Airflow curve

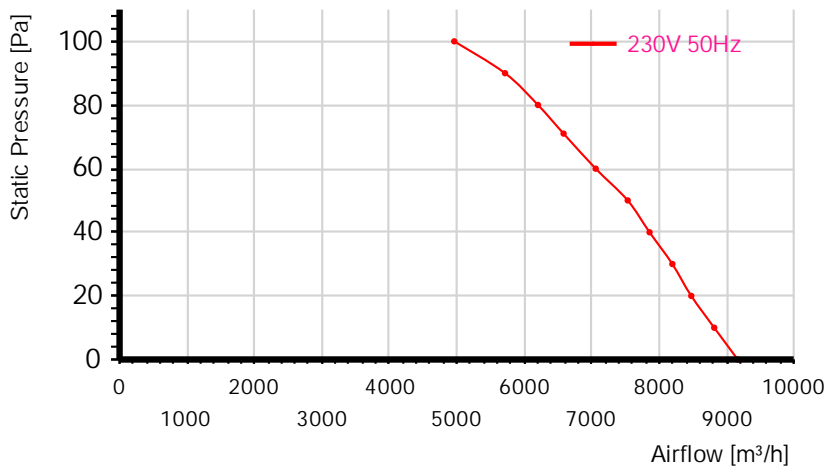

Power input curve

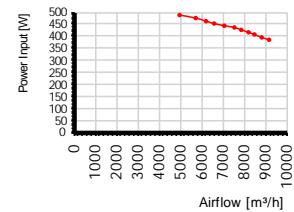

Efficiency on static pressure

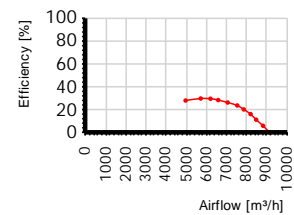

## Performance test with reference to GB/T 1236-2017, equivalent to ISO 5801

TestID		2012110903			Capacitor			14 uF		
Test environment										
Outlet size		Outlet area		Temperature		Humidity		Baropressure		Density
635mm		0.3167m²		19℃		82%		102kPa		1.2kg/m³
Test data										
Voltage	Frequency	Speed	Power input	Current	Airflow	Static pressure	Dynamic pressure	Total pressure	Pressure Difference	Nozzle Size
V	Hz	r/min	W	A	m³/h	Pa	Pa	Pa	Pa	mm
231.4	50	912	488	2.21	4962	100	11	112	220	150+189*2
231.2	50	917	476	2.16	5716	90	15	105	292	150+189*2
230	50	920	463	2.12	6204	80	18	98	343	150+189*2
230	50	924	453	2.08	6584	71	20	91	204	150+189*3
231	50	929	444	2.04	7059	60	23	84	234	150+189*3
232.1	50	932	437	2.02	7534	50	26	76	266	150+189*3
232	50	935	427	1.98	7858	40	29	69	289	150+189*3
231.1	50	938	417	1.94	8197	30	31	62	315	150+189*3

Model:YWF(K)6E630-Z-B5A

Fan type:AC Axial fan

232.2	50	941	408	1.91	8476	20	33	53	336	150+189*3
231.3	50	945	396	1.87	8818	10	36	46	364	150+189*3
230.8	50	946	386	1.85	9165	0	39	40	393	150+189*3

## Dimensions(in mm)

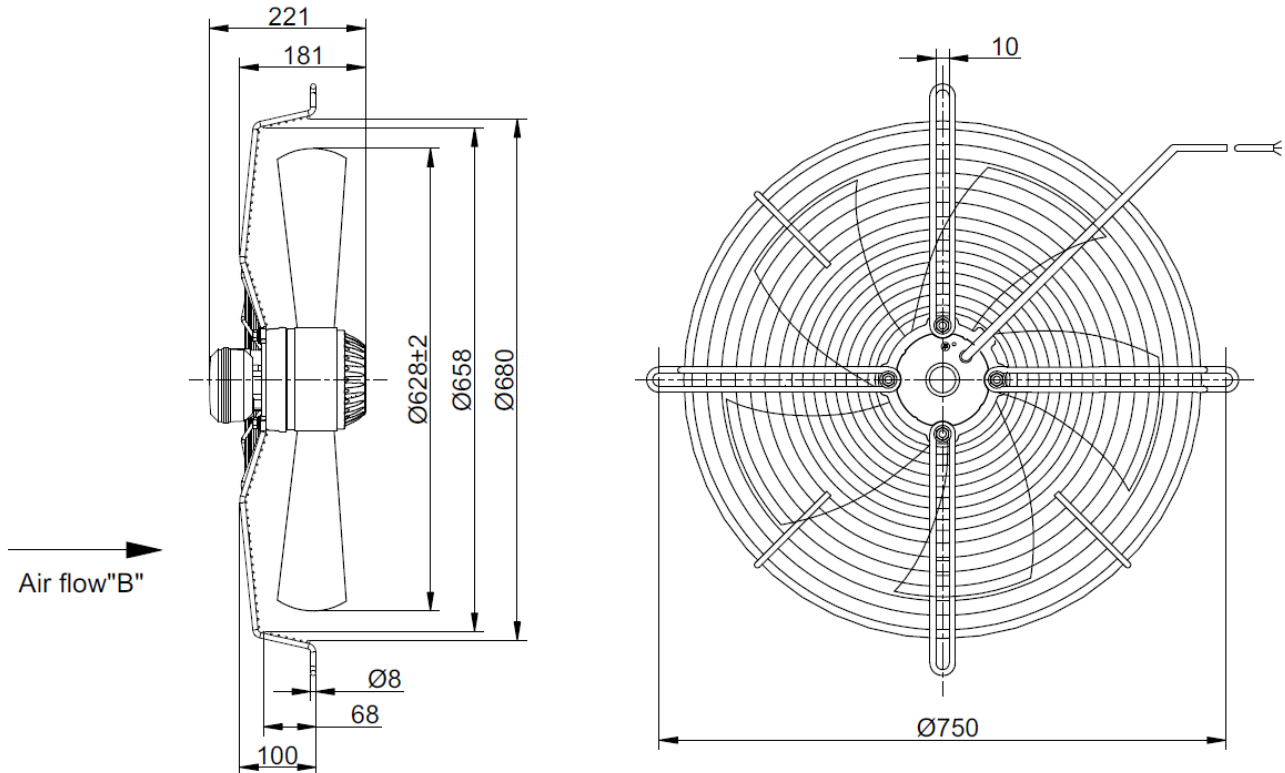

## Wiring diagram

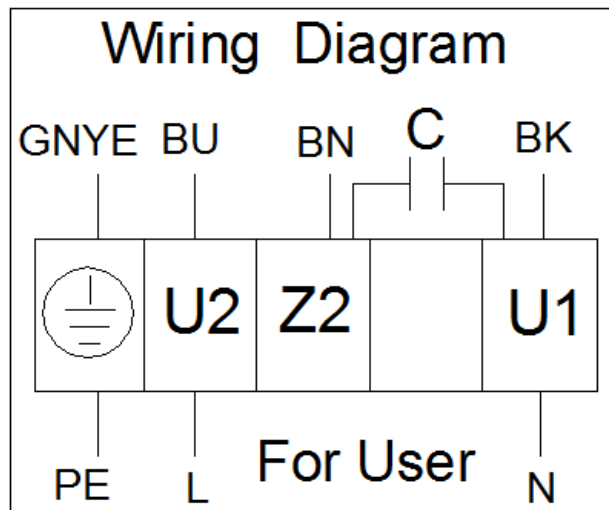

Model:YWF(K)6E630-Z-B5A

Fan type:AC Axial fan

## Attentions

- ★Please check the appearance and the accessories if there is no damage before use, check the model is consistent with requirements;
- ★Keep reliable grounding according to the wiring diagram. to avoid motor burning and personal accident, please check wiring is loose or fall off;
- ★Before connect the power supply, check whether the motor is reliable, otherwise it will cause motor damage and personal injury;
- ★It is forbidden to pull the power cable, if the power cable is damaged, to be repaired before use, to avoid the accident of electric shock;
- ★Drop or impact motor is forbidden;
- ★Washing motor with water is prohibited, it will reduce the motor insulation level, even lead to electric leakage even endanger personal safety;
- ★Special customized product is designed for specified requirements, please consult with our engineers before change useage;
- ★The temperature of the motor shell may be higher in a short time after the fan stopped, Please avoid direct contact with the motor surface. If necessary, please take protective measures to prevent scald;
- ★Do not contact the impeller when the fan running, you need to wait for all the parts stopped before operate it;
- ★When the fan is installed, check and ensure thers is no debris in the shell and other shell body, keep the fan clean;
- ★After the fan installation complete, before connected to supply, please confirm that there is no collision or interference or stuck.

## Service life, maintenance, warranty and Disclaimer

- The design life of this product is 40,000 hours. This data is derived from the expected life of L10 for general ball bearings at 40℃ is 40,000 hours. The actual service life of the product is affected by the use environment (temperature, humidity, installation, bearing load, etc.).

Model:YWF(K)6E630-Z-B5A

Fan type:AC Axial fan

- According to the use of the environment, please make a clean maintenance every 3~6 months.
- From the date of purchase (order delivery date), The warranty period is one year. During this period, for failure due to the quality of the product itself, we provide free replacement or repairing. If the damage caused by improper disassembly, transportation, artificial damage or natural disasters, etc., is not in the scope of this warranty;
- All AC fans should be used according to the specified voltage range and power frequency. It is not recommended to use frequency converters and voltage regulators as speed control devices. If necessary, you need to make technical confirmation with our sales before placing an order. The use of unconfirmed speed control devices leads to the reduction of product life, abnormal noise, operating failures, etc., which are not covered by this warranty;